

Product Configuration Technical Specification Sheet

Cyclo® 6000

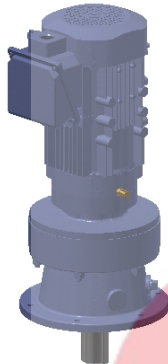

Basic Product Information	
Model Number	CVVM2-6145DBY-EP-319
Cyclo® Frame Size	6145DB
Housing Style	(V) V-Flange Mount
Shaft Orientation	(V) Vertical Down
Output Shaft Specification	(Y) Standard Inch Size
Input Configuration	(M) Integral Motor

Application Information	
Ratio	319
Input / Output RPM	1750 / 5.49

NOTE: Information displayed on this technical specification sheet will vary, as it is based upon your actual selections. Please see next page for more configuration specific information.

Dimensions shown are for reference only and are subject to change without notice, unless certified. Certified prints are available after receipt of an order; consult factory for more information. Image shown is representative and may not reflect actual unit and/or orientation.

Unmatched Reliability, Exceptional Performance

Cyclo® speed reducers and gearmotors are designed to withstand shock loads exceeding 500% of their ratings

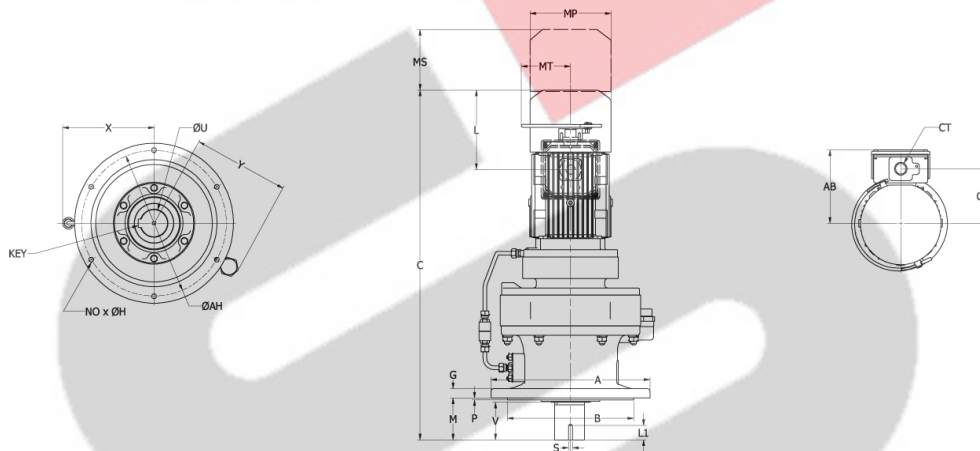

Units: inch Approximate Weight: 137 lb

Casing	A	B	B TOL.	C	G	H	NO	M	P	AH	X	Y
	10.24	7.8740	-0.002 / -0.0048	24.84	0.59	0.43	6	3.78	0.16	9.06	-	-

Output Shaft	U	U TOL.	V	S	L1	KEY
	1.8750	0 / -0.0006	3.19	3/8-16UNC	0.79	1/2 x 1/2 x 2.95

Integral Motor	AB	L	MP	MS	MT	CP	CT
	6.16	3.82	□6.58	-	-	4.57	NPT 3/4

Product Configuration Technical Specification Sheet

Input Configuration		Product Ratings	
Input Stage Frame Size	609	Application or Motor Input Power	2.01 HP
Gearmotor		Service Factor	0.58
Motor Series	EPNA Prem. Eff. UL/CSA	Calculated Output Torque	20800 in-lbs
Motor Frame / Type	N-90L / TEFC	Rated Input RPM	1750
HP x Pole Rating	(2) 2HP [1.5kW] 4P	Rated Output RPM	5.49
Motor Voltage Rating	230/460V, 60Hz, 3Phase	Product Rated Input Power	1.17 HP
Conduit Box Type	Global Type	Product Rated Output Torque	12100 in-lbs
Inlet Size	NPT 3/4	Product Overhung Load Capacity	1690 lbf
C. Box / Port Direction	N33 / N3B		
Add Brake	No		
Lubrication Specifications		Reducer Options	
Lubrication Requirement	Standard Lubrication	Mill Duty	Option Not Selected
Lubrication Method	Grease	Chemical Duty	Option Not Selected
Lubrication Option	Standard Grease	Dusty, Weather Proof IP54	Option Not Selected
		Food & Washdown Options	None Selected
		Ductile Iron Housing	Option Not Selected
		High Capacity Bearing	Option Not Selected
		Shoulder Bolts / Dowel Pins	Option Not Selected
		Eccentric Backlash Reduction	Option Not Selected
		Seal Options	Nitrile Seal
		Double Output Oil Seals	Standard (Vertical Unit)
		Paint Specification	Danube Blue
Environmental Specifications			
Installation Location	Indoor		
Ambient Temperature	14° - 104°F (-10° - 40°C)		
Ambient Humidity	Under 90%		
Environment	Standard		
Food Grade Required	No		
Elevation Above Sea Level	Under 3300 ft/1000 m		
Configuration Messages			
Output Shaft Overhung Load (OHL) Capacity			
The Output Shaft OHL Capacity needs to be checked if Output Shaft is not direct coupled to the application. Using the Product Overhung Load Capacity value from the Selection, please check it against the actual OHL using the method described in the Catalog. If Cyclo unit will see significant vibration from the application and the Cyclo output shaft will not be direct coupled to the application, please consult the Factory for additional guidelines on Service Factor adjustment.			

All Configuration data contained within this technical specification sheet is subject to change. Please refer to Sumitomo Drive Technologies' Terms and Conditions located at smcyclo.com for further information. For more specific product and/or application data, please contact your Sumitomo Drive Technologies' Representative.

To request a catalog, or for more information, on any of our high quality products, please visit our website: www.sumitomodrive.com.

Thank you for your interest in Sumitomo products.